

ARCHITECTURAL MODULAR SERIES

INSTALLATION OPTIONS

TAPE & SILICONE INSTALLATION

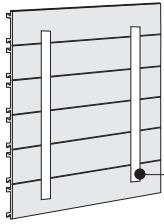

REAR VIEW -
Without assembly bars.
(Signs up to 4 15/16" High)

Double Stick tape

All surfaces must be clean, dry and free from dust, oil or any foreign matter.

Double Stick foam tape only for:

- signs up to 8 1/4" X 8 1/4" approx.
- stable environment
- smooth surfaces

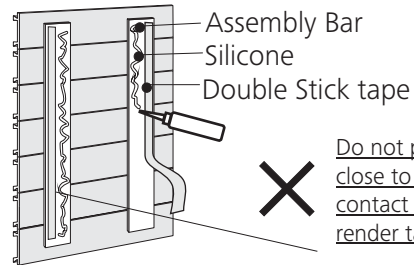

Do not put silicone close to tape, contact with tape will render tape useless.

REAR VIEW - With Assembly Bars.
(Signs from 5 3/4" & up in height)

Double Stick foam tape & silicone for:

- signs up to 24 3/4" x 24 3/4" approx.
- smooth surfaces

SCREW FIX INSTALLATION

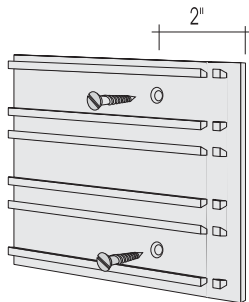

FRONT VIEW

Screw fixing is recommended for:
Signs above 24 3/4" x 24 3/4".

Drill counter sunk holes 2" in from the edge of the Base Plate, central in the track
The screw head must not protrude beyond the tracks.

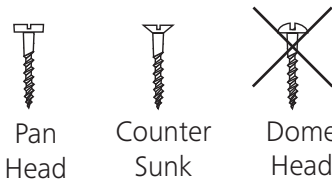

Pan Head

Counter Sunk

Dome Head

* Systech Signage Technology will not be held responsible for incorrect installation. All installations must be assessed on their own merit by the installer.

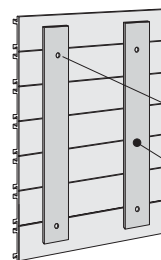

REAR VIEW

Counter Sunk Holes

Assembly Bar

Signs provided with assembly bars must be fixed at this point. Do not fasten signs in between assembly bars unless appropriate spacers are used.

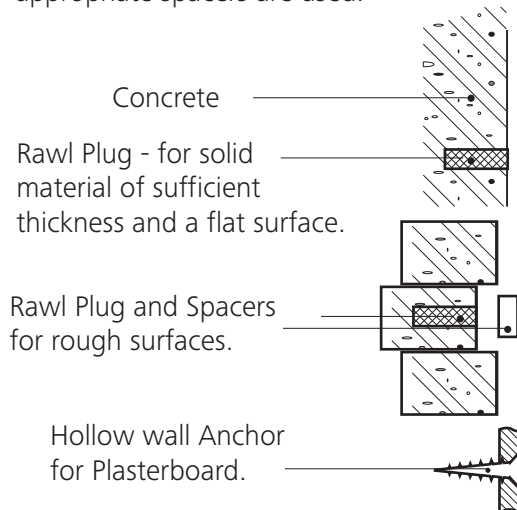

Concrete

Rawl Plug - for solid material of sufficient thickness and a flat surface.

Rawl Plug and Spacers for rough surfaces.

Hollow wall Anchor for Plasterboard.